

Import image data to OMERO: via OMERO.web

Remote Import for dedicated microscope workstations only!

1 Preparation on the microscope workstation:

- Navigate on the microscope workstation to the existing OMERO_ImportData folder
- Create a folder named like your user name in OMERO and store your data there

You can now continue on any PC with a internet connection

2 Open a webbrowser and navigate to *omero.cellnanos.uni-osnabrueck.de* and login into OMERO.web

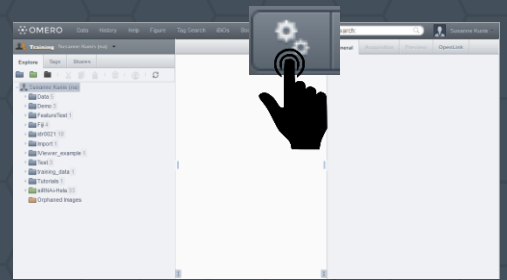
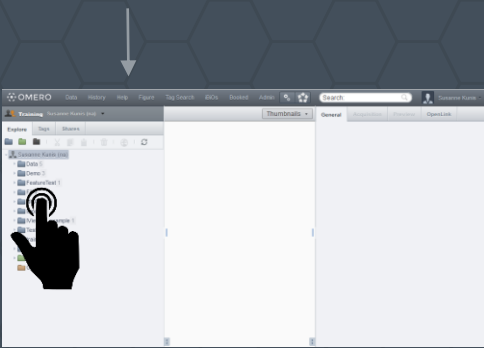

3 Select the target project or dataset where you want to store the data

4 Click on the wheel icon in the middle top

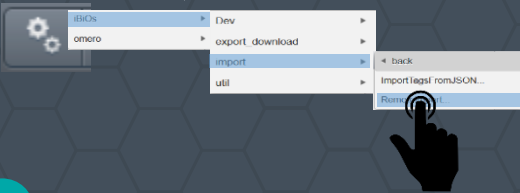

5 Select *iBiOs>import>RemoteImport*

Remote Import.py

Remote import from dedicated workstations:
* Import the content of the OMERO_ImportData/-username-/ folder on the selected workstation.
* Appends files with the specified suffix to the Project or Dataset.
* The scanned subfolder depth is 10

INPUT:

Select PROJECT as TARGET for import : A Dataset object is created for each subdirectory on OMERO_ImportData/-username-/ folder on the selected workstation.
Select DATASET as TARGET for import : All images (also images in subdirectories) are imported into this Dataset
Authors: Susanne Kunis, CellNanos
Contact: sukunis@uos.de
Version: 1.0.0

Workstations:
Data Type:
IDs: *5501
Skip already imported files:
Attach non image files:
Attach to object type:
Filter attachment by extension:

Microscope with your data

Target Project or Dataset

Attach files automatically

Remote Import.py

Remote import from dedicated workstations:
* Import the content of the OMERO_ImportData/-username-/ folder on the selected workstation.
* Appends files with the specified suffix to the Project or Dataset.
* The scanned subfolder depth is 10

INPUT:

Select PROJECT as TARGET for import : A Dataset object is created for each subdirectory on OMERO_ImportData/-username-/ folder on the selected workstation.
Select DATASET as TARGET for import : All images (also images in subdirectories) are imported into this Dataset
Authors: Susanne Kunis, CellNanos
Contact: sukunis@uos.de
Version: 1.0.0

Workstations:
Data Type:
IDs: *5501
Skip already imported files:
Attach non image files:
Attach to object type:
Filter attachment by extension:

6 Type in your specifications

7 Click: Run Script